

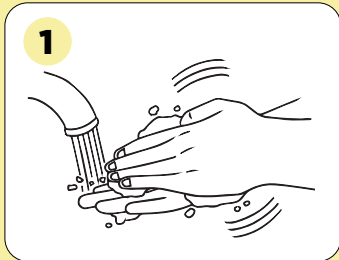

TO PUT ON:



1
WASH HANDS WITH SOAP & WATER FOR 20 SECONDS OR USE HAND SANITIZER.



2
COVER MOUTH AND NOSE WITH THE MASK.

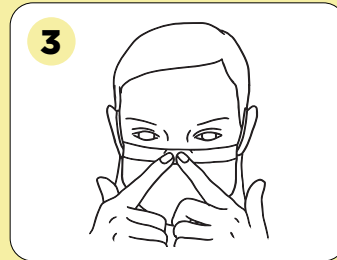

3
FIT THE FLEXIBLE BAND TO THE NOSE BRIDGE.

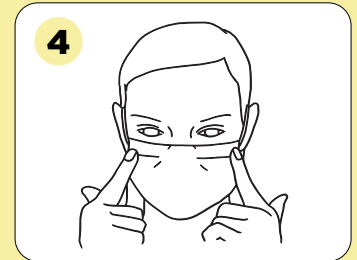

4
MAKE SURE THERE ARE NO GAPS.

WHILE ON:

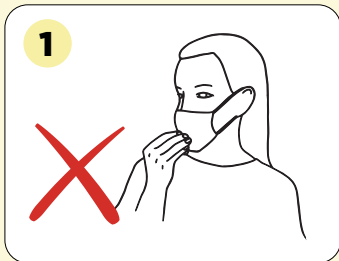

1
DO NOT TOUCH THE MASK WHILE USING IT.

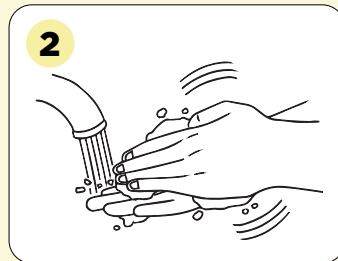

2
IF YOU DO, WASH HANDS WITH SOAP & WATER FOR 20 SECONDS OR USE HAND SANITIZER.

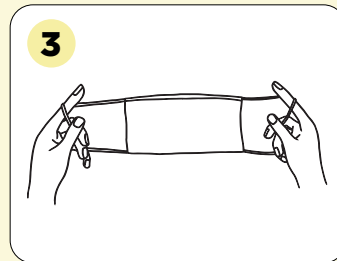

3
REPLACE THE MASK WITH A NEW ONE ONCE IT BECOMES DAMP.

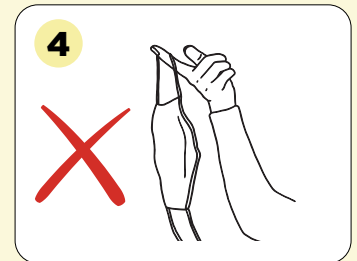

4
DO NOT RE-USE SINGLE USE MASKS.

TO TAKE OFF:

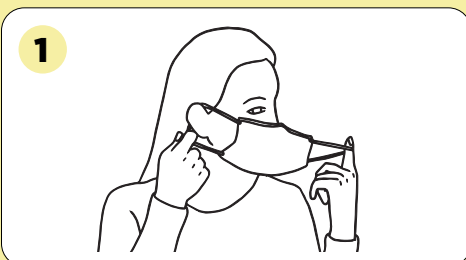

1
DO NOT TOUCH THE FRONT OF THE MASK! REMOVE IT FROM BEHIND.

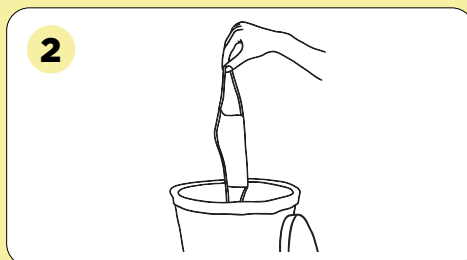

2
THROW AWAY THE MASK INTO A LINED GARBAGE WITH A LID.

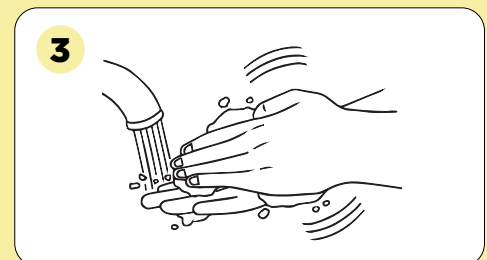

3
WASH HANDS WITH SOAP & WATER FOR 20 SECONDS OR USE HAND SANITIZER.

HOW TO WEAR A MASK



TO PUT ON:

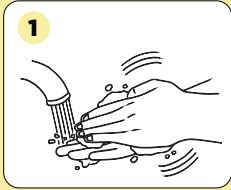

1
WASH HANDS WITH SOAP & WATER FOR 20 SECONDS OR USE HAND SANITIZER.

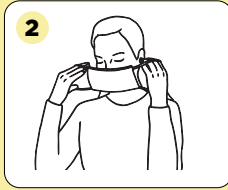

2
COVER MOUTH AND NOSE WITH THE MASK.

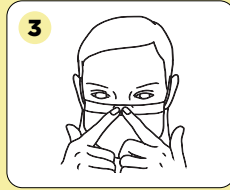

3
FIT THE FLEXIBLE BAND TO THE NOSE BRIDGE.

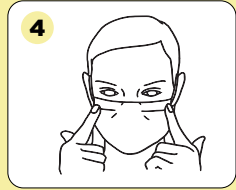

4
MAKE SURE THERE ARE NO GAPS.

WHILE ON:

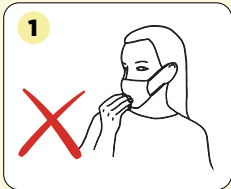

1
DO NOT TOUCH THE MASK WHILE USING IT.

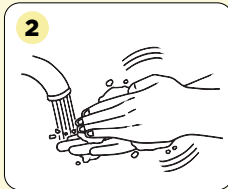

2
IF YOU DO, WASH HANDS WITH SOAP & WATER FOR 20 SECONDS OR USE HAND SANITIZER.

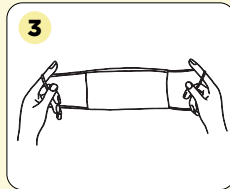

3
REPLACE THE MASK WITH A NEW ONE ONCE IT BECOMES DAMP.

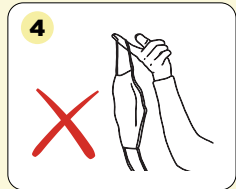

4
DO NOT RE-USE SINGLE USE MASKS.

TO TAKE OFF:



1
DO NOT TOUCH THE FRONT OF THE MASK! REMOVE IT FROM BEHIND.

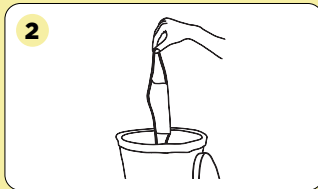

2
THROW AWAY THE MASK INTO A LINED GARBAGE WITH A LID.

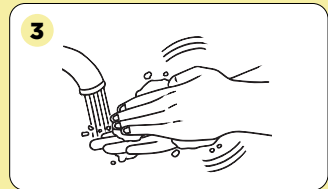

3
WASH HANDS WITH SOAP & WATER FOR 20 SECONDS OR USE HAND SANITIZER.